

aoqufu

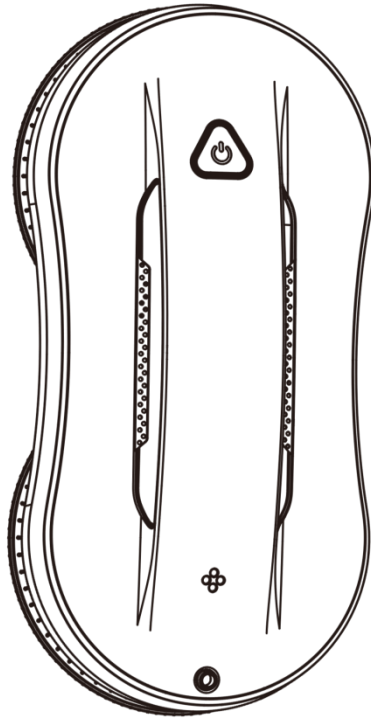

Window Cleaning Robot User Manual

Thank you for purchasing this product. Please read this manual carefully before use to ensure proper operation and optimal performance.

Content

1. Important Safety Instructions and Important Safeguards	2 - 3
2. Product Description & Parameters	4 - 5
3. Steps for Usage	6 - 7
4. Function of Cleaning	8 - 9
5. Power Failure Protection (Backup Battery)	9
6. The Remote Control	10
7. Troubleshooting	11-12
8. Warranty	13

1. Important Safety Instructions and Important Safeguards

1. Caution: Read Carefully Before First Use

1. Do not allow children to operate this product. This product must not be used by children or treated as a toy. Users with physical, sensory, or psychological impairments, or those lacking adequate knowledge about the functions and operation of the product, must only use it under the supervision of a fully competent adult. Such users should be thoroughly familiar with the usage procedures and safety risks before operating the product.

2. This product is only suitable for cleaning framed windows and glass. It is not suitable for frameless glass surfaces. If the sealant (glass cement) of the window frame is damaged or aged, suction pressure may be insufficient, increasing the risk of falling. During use, please observe the working environment carefully and supervise the robot at all times to ensure safe and secure operation.

2. Important Safeguards

- Please read this manual carefully before using the product and keep it for future reference. Always follow the provided instructions during operation. If you encounter any issues that you cannot resolve, please contact customer service directly. Unauthorized repairs may result in personal injury and void the warranty.
- The robot is not suitable for curved, uneven, or damaged glass surfaces, including glass with joints, cracks, decorative elements, attached films, or specially shaped (e.g., circular) designs. Use on such surfaces may compromise suction performance and operational safety.
- Always use the original power adapter. Using a non-original adapter may cause the product to malfunction or become damaged.
- Ensure the power adapter is well-ventilated during use. Do not cover it with any objects that may block heat dissipation.
- Do not use the adapter in humid environments. Avoid touching it with wet hands during operation. The correct operating voltage is indicated on the adapter nameplate.
- Do not use a damaged power adapter, charging cable, or plug. Before cleaning or performing maintenance, unplug the power—do not disconnect by removing the extension cord to prevent electric shock.
- Do not attempt to disassemble the power adapter. If it malfunctions, replace the entire adapter. For assistance, contact your local customer service or distributor.
- Do not disassemble the battery. Never dispose of it in fire, or use it in environments exceeding 60°C. Mishandling the battery may result in fire or chemical injury.
- The built-in battery must only be replaced by the manufacturer or an authorized service center.
- Before removing or disposing of the battery, ensure the power is disconnected.
- Dispose of used batteries at a certified battery or electronics recycling center.
- Do not immerse the product in any liquids (such as water, beverages, or alcohol) or leave it in humid environments for extended periods.
- Store the product in a cool, dry place, away from direct sunlight and heat sources (e.g., radiators, heaters, microwaves, stoves).
- If the product will not be used for an extended period, please fully charge it and turn it off before storage. To prevent battery failure due to long-term storage, recharge the product at least once every three months.
- Keep the product away from strong magnetic fields.
- Store the product out of reach of children.
- Use the product only in ambient temperatures between 0°C~40°C (32°F~104°F).
- The manufacturer is not responsible for any damage or personal injury caused by improper use of this product.

Attention

1. Before use, please ensure the safety rope is intact, with one end securely attached to the robot and the other firmly fastened to a stable object indoors. This is to prevent the window cleaning robot from falling and causing damage or injury.
2. If the window sealant is peeling in the middle or there are chips at the corners due to aging, please use the robot with caution. Ensure that a user supervises the robot during operation to prevent it from falling and potentially causing injury or damage.

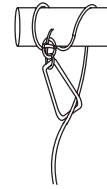

3. Risk of Electric Shock

- Always ensure the power is completely disconnected and the robot is turned off before cleaning or performing maintenance.
- Do not unplug the power cord by pulling on the extension cable; always unplug it properly from the socket.
- Do not use the product if the robot or power supply appears damaged.
- If the robot is damaged, contact your local after-sales service center or authorized dealer for repair.
- Do not clean the robot body or power adapter with water.
- Do not operate this product near open flames, running water (e.g. in bathrooms), swimming pools, or any other hazardous environments.
- Do not bend, twist, or damage the power cord. Avoid placing heavy objects on the power cord or adapter to prevent damage.

4. Important Precautions Before Use

1. Before operation, ensure the safety rope is properly attached to the robot and securely fastened to a stable indoor object.
2. Check the safety rope for any damage and confirm that the knot is secure before powering on the robot.
3. If using the robot on windows or doors without a balcony, place a danger warning sign on the ground below to alert people.
4. Fully charge the built-in backup battery before use (the indicator light should be green).
5. Do not use the robot during rainy or humid weather conditions.
6. Turn on the robot before placing it on the window glass.
7. Ensure the robot is firmly attached to the glass surface before releasing your hands.
8. In case of a power outage, ensure the robot is safely removed before the backup battery runs out.
9. Do not use this product to clean frameless windows or glass panels.
10. Ensure the cleaning cloth is securely attached to the bottom of the robot to prevent air leakage and ensure proper suction.
11. Do not spray water directly on the robot or its underside. Only spray water onto the cleaning cloth.
12. Keep children away from the robot. Do not allow children to operate or play with the device.
13. Remove any objects from the glass surface before starting the cleaning process.
14. Keep hair, loose clothing, fingers, and other body parts away from the robot's moving parts during operation.
15. Do not use the robot in environments with flammable or explosive materials or gases.

2. Product Description & Parameters

1. Product Description

1. The Window Cleaning Robot is designed to provide efficient and intelligent glass cleaning for various home environments. It adheres securely to vertical or inclined glass surfaces using a powerful vacuum motor, ensuring safe and stable operation throughout the cleaning process. The suction capability is generated by the high-speed rotation of the main motor, similar to the principle of a vacuum cleaner, which creates strong adhesion to the glass surface.

2. Once attached, the robot is driven by two walking motors that rotate the dual cleaning wheels. These wheels serve both movement and cleaning functions and are equipped with removable and replaceable microfiber cloths to deliver outstanding cleaning results. The robot is especially effective on large glass areas, helping users reduce effort while maintaining clarity and cleanliness.

3. Equipped with advanced artificial intelligence, the robot automatically plans optimal cleaning paths, detects window edges, and ensures comprehensive coverage of the entire surface. For added flexibility, users can also switch to manual control mode via the included remote controller.

4. This upgraded model features enhanced AI technology, a more compact and modern design, and significantly improved cleaning performance. It operates with a constant power supply via the included power cord, as the high power demands of the motors prevent it from running solely on battery power. However, a built-in backup battery provides short-term emergency power to keep the robot safely attached to the glass in the event of a power outage.

Please note: Due to the high-speed operation of the main motor, the robot may produce some noise during use. This is a normal part of its function, and we appreciate your understanding.

2. Specifications

Input Voltage	AC 200 ~ 240V 50Hz ~ 60Hz
Rated Power	72W
Battery Capacity	500mAh
External Dimensions	295*145*80mm
Suction Power	2600 - 3000Pa
Net Weight	1085g
Power Failure Protection Time	20min
Control Method	Remote Control
Noise Level	65 -70dB
Border Detection	Automatic
Fall Arrest Control	Power failure protection (backup battery) and safety rope
Cleaning Mode	Intelligent path plan + Manual control
Water Tank Capacity	50ml
Water Spraying Method	Manual / Auto
Minimum Using Area	350*350mm

3. Product Component

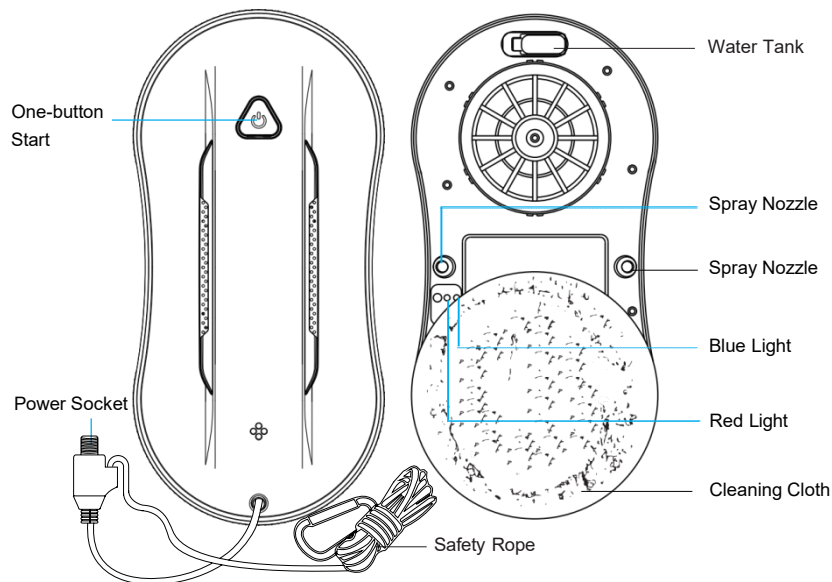

Power Light Status Indicator

Orange Light : Charging in progress

Green Light : Charging complete

Blue Light : Robot is working normally

Red Light : Robot error or abnormality

4. Product Accessories

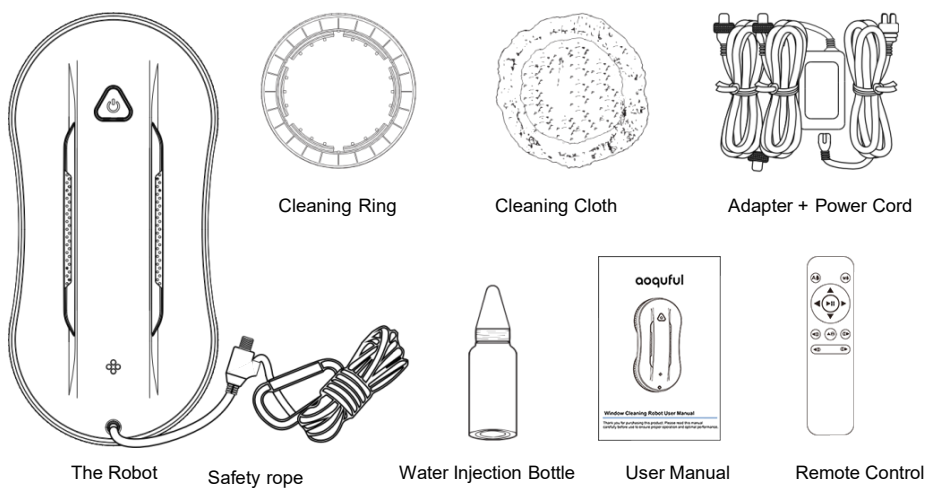

3. Steps for Usage

1. Connect the Power

- Connect the AC power cord to the adapter.
- Insert the threaded connector into the robot's power socket and tighten it securely.
- Plug the power cord into a wall outlet.

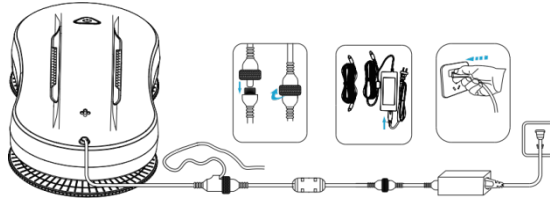

Note: The built-in battery serves as a backup power source in case of power failure. Please ensure the battery is fully charged before use (green light indicates full charge).

- When the robot is off and charging, the indicator shows orange .
- When fully charged, the indicator turns green.

2. Install the Cleaning Cloth and Cleaning Ring

Following the illustrated instructions, attach the cleaning pad to the cleaning ring. Align the "Pairing" marker on the ring with the cleaning wheel and press evenly to ensure the ring is securely mounted. This ensures proper air pressure and prevents leakage.

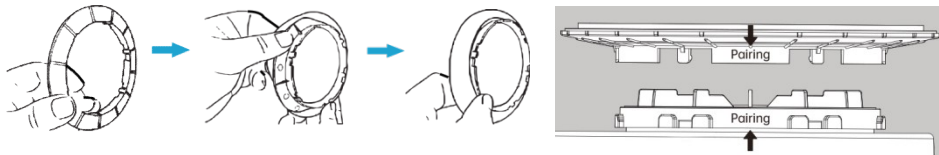

3. Attach the Safety Rope

- If using on glass doors or windows without a balcony, place a warning sign on the ground below to ensure pedestrian safety.
- Always attach the safety rope before operating the robot. Securely tie it to a stable indoor fixture to prevent falls.
- Before each use, check the rope for any signs of wear or damage, and ensure the knot is tight and secure.

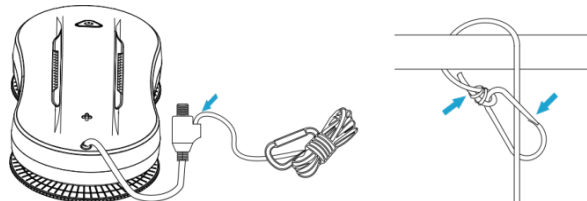

4. Fill the Water Tank

- A. Do not add any cleaning agents or chemicals to the water tank—use **ONLY** clean, impurity-free **WATER**. Cleaning liquids, glass cleaners, or other chemical solutions may damage the spray nozzle or affect the misting performance.
- B. Turn the robot upside down, remove the cleaning ring, open the silicone cover, and fill the tank with water. (Refer to Figure1, Figure2, Figure3)
- C. Do not overfill the water tank—fill to about 80% capacity to maintain stable air pressure.

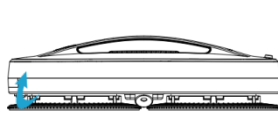

Figure1

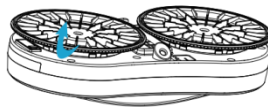

Figure2

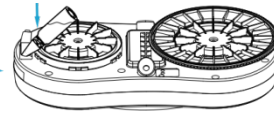

Figure3

5. Attach the Robot to the Glass

- A. Press and hold the power button for 2 seconds to turn on the robot. Ensure the motor starts operating.
- B. Place the robot on the glass surface, leaving some distance from the window frame.
- C. Confirm that the robot is firmly attached to the glass before releasing your hand.



6. After Cleaning is Complete

- A. With one hand holding the robot, press and hold the power button for 2 seconds to turn it off.
- B. Carefully remove the robot from the glass.
- C. Hold the robot and pour out any remaining water to prevent water residue from forming scale, which could affect the performance of the nozzles.
- D. Untie the safety rope and place the machine and its related accessories in a dry and ventilated environment for next use.

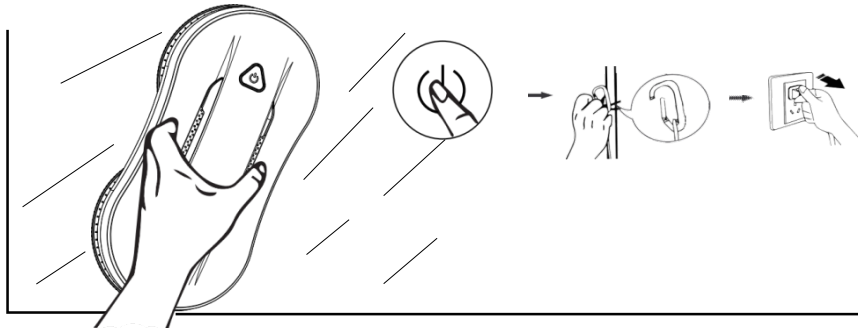

4. Function of Cleaning

1. Dry Wipe

A. For the first cleaning pass, make sure to use dry wipe mode without spraying any water. This is to remove dust and sand particles from the glass surface.

B. If you spray water or detergent before removing the sand, it may mix with the sand to form yellowish mud, resulting in poor cleaning performance.

C. Dry wiping is especially recommended in sunny or low-humidity weather conditions.

Noted: If the glass is only lightly soiled, you may spray a small amount of water on the glass surface or the cleaning cloth to improve traction and avoid slipping.

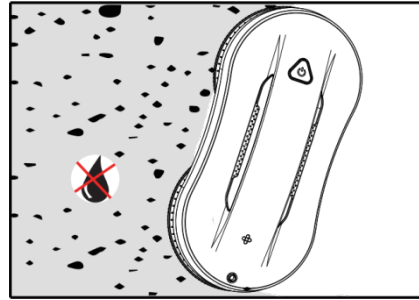

2. Wet Wipe

The window cleaning robot is equipped with dual spray nozzles. It sprays water from the left nozzle when moving left, and from the right nozzle when moving right, allowing targeted cleaning.

1. Automatic Water Spray Mode (A)

A. When the robot begins cleaning, the automatic water spray mode is enabled by default. The robot sprays water intermittently during operation.

B. Press the (A) button on the remote control. If you hear two beeps, it means automatic water spray mode is enabled.

C. Press the (A) button again. If you hear one beep, it means automatic water spray mode is disabled.

2. Manual Water Spray Mode (M)

When the window robot is cleaning, press the (M) button on the remote control to manually spray water once.

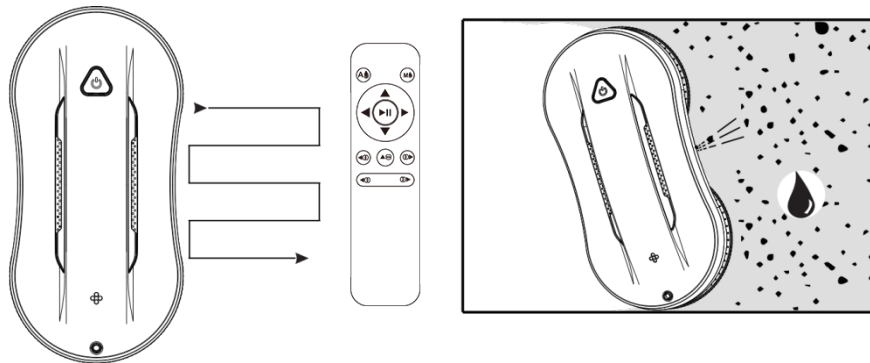

3. Intelligent Path Planning Modes

The robot offers multiple intelligent cleaning path options to ensure thorough cleaning:

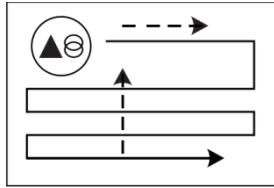

Climb to the top and then automatic clean

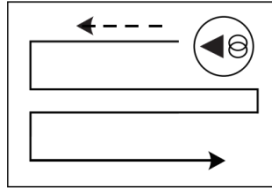

Auto clean from right to left

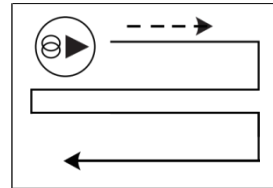

Auto clean from left to right





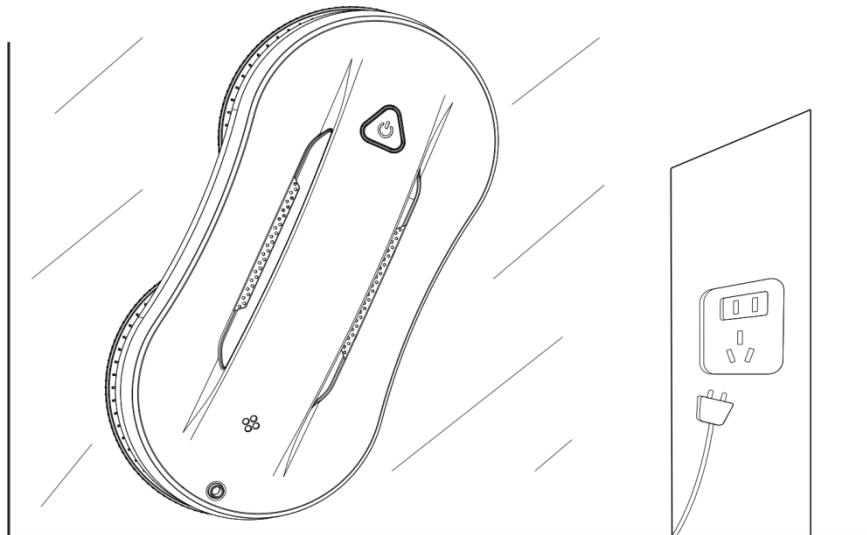



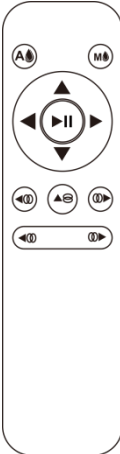

5. Power Failure Protection (Backup Battery)

- A. In case of a power outage, the built-in backup battery will automatically activate. When fully charged, it can provide emergency power for up to 20 minutes.
- B. During a power failure, the robot will stop moving and remain securely attached to the glass. It will emit a warning sound, and the red and blue lights will flash alternately. Please take down the robot as soon as possible to prevent it from falling due to battery depletion.
- C. To retrieve the robot safely, gently pull it back using the safety rope. Keep the rope close to the glass surface to minimize the risk of detachment or impact.



6. The Remote Control

- A. **Battery Safety:** Do not attempt to charge the remote control battery, disassemble it, or expose it to fire, as there is a risk of explosion.
- B. **Battery Specification:** Use only AAA/RL batteries of the specified type. Do not mix different types of batteries, as this can cause damage to the circuit. When installing or removing the battery, slide the remote control cover down to open the battery compartment. Insert the battery, ensuring the negative terminal aligns with the spring end first. Incorrect installation of the battery will render it nonfunctional. Once the battery is installed, close the battery cover.
- C. **Battery Compatibility:** Never mix old and new batteries or different models/types of batteries. This could lead to malfunction or damage.

 Climb to the top and then automatic clean	 Manual upward movement	
 Auto clean from right to left	 Manual downward movement	
 Auto clean from left to right	 Manually move to the left	
 Automatic water spray	 Manually move to the right	
 Manual water spray	 Start/Pause	

7. Troubleshooting

1.If the window glass hasn't been cleaned for a long time and has stubborn stains (such as bird droppings, insect marks, mud spots, sand, or grease):

Please spray water or glass cleaner directly on the stains using a spray bottle and wait for about 30 minutes to soften them. Then, manually remove the stains and any hard debris with a soft cloth or scraper to prevent hard particles in the dust from scratching the glass surface.

2.How to clean windows with a lot of dust?

We recommend manually removing surface dust first, as dust mixed with water can turn into sludge, making cleaning more difficult. After that, use the window cleaning robot in the following sequence: dry wipe → wet wipe → dry wipe. During the cleaning process, please replace the cleaning cloths promptly to ensure optimal cleaning performance.

3. Is it compatible with frameless glass?

The window cleaning robot is suitable for vertical, seamless, and smooth surfaces such as glass windows, tiled walls, marble, or mirrors. It is equipped with edge-detection sensors that can recognize frameless edges to a certain extent. However, since frameless glass lacks physical boundaries, there is a risk that the robot may move beyond the intended cleaning area. Therefore, it is recommended to monitor the robot during the cleaning process of frameless glass and manually assist in repositioning if necessary to ensure complete and safe coverage of the cleaning area.

4.Robot runs slowly or fails when using the cleaning cloth for the first time (especially on dirty outer window glass):

- A. When unpacking the robot, clean with a clean cleaning cloth.
- B. Spray a little water or glass cleaner evenly on the cleaning cloth or the surface of the glass to be wiped.
- C. After dampening the cleaning cloth and wringing it out until it no longer drips, place it into the cleaning ring for use.
- D. The long fiber side is the front of the cleaning mops. Please avoid using it in reverse.
- E. Normally, it's unnecessary to disassemble the cleaning rings for cloth replacement. If removal is needed, please carefully pair and align the cleaning bracket with the corresponding concave and convex slots. Ensuring proper alignment helps avoid air leakage and maintains stable performance.
- F. If the red light still flashes, it may indicate insufficient air pressure. Please check whether the cleaning rings and mops, or the cleaning rings and cleaning wheels, are properly paired and assembled. Reinstall them to ensure a secure fit.

5. The robot doesn't run smoothly, and there is a warning sound.

This issue may occur during the self-check at the beginning of operation. Possible causes include:

- A. The cleaning cloth is too dirty, leading to reduced friction and impaired movement.
- B. The surface has low friction materials (e.g., window film, frosted glass, or insulation film), which may affect the robot's grip.
- C. The glass surface is overly clean or dry, resulting in insufficient friction.
- D. In low-humidity environments (such as air-conditioned rooms), the glass may become too slippery after repeated wiping.

6. When pressing the upward automatic cleaning button, the robot may fail to detect the upper edge of the window due to slipping near the top frame:

Please switch to "Climb-to-Top", "Left to Right" mode or "Right to Left" mode to continue operation.

7. The robot cannot clean the upper left side of the glass:

Use the manual cleaning mode via the remote control to clean the area that wasn't wiped (sometimes the glass or cleaning cloth may be slippery, or the glass width is too large, causing the top line to slide and the upper left part to remain unwiped).

8. The robot finishes cleaning ahead of time and doesn't complete the entire window:

Press the "Left to Right" or "Right to Left" auto clean mode to continue the unfinished cleaning.

9. The robot cannot climb or slips while climbing:

- A. The friction coefficient may be too low (e.g., stickers, thermal insulation stickers, or fog stickers).
- B. The cleaning cloth may be too wet. After dampening the cleaning cloth, please wring out the excess water before use.
- C. The glass may be too clean and slippery.
- D. Low humidity (e.g., air-conditioned rooms) can make the glass slippery after multiple wipes.
- E. When starting the robot, ensure the robot is placed at a distance from the window frame to avoid incorrect detection.

F. If the robot stops working or struggles to move during cleaning, please remove it from the glass, replace the cleaning cloth with a new one, and spray a small amount of water evenly onto each cloth. Then restart the robot to resume cleaning.

10.Round wheel marks left on the glass after cleaning:

- A. The cleaning cloth may be too dirty. Replace it with a clean cloth and wipe again.
- B. We recommend following this cleaning sequence: start with dry wiping to remove dust, then perform wet wiping to clean the surface, and finally use dry wiping again to remove any remaining moisture. This process helps achieve the best cleaning results.

11.The robot doesn't run smoothly:

- A. Replace the dirty cleaning cloth promptly, as dirt and debris can accumulate on the cloth over time, reducing cleaning performance. Timely replacement ensures optimal cleaning results.
- B. The glass surface may have different areas (e.g., glass, sticker, thermal insulation sticker, or fog sticker area). Use the robot on a single area.
- C. If the cleaning wheel screw is loose, tighten it (but not too tightly, as it may affect the robot's working performance).

12.How to handle the warning sound and red light flashing when the robot stops due to power failure:

- A. Gently pull the safety rope back to the robot, ensuring it is close to the parallel glass to avoid falling.
- B. Turn off the robot's power switch.
- C. Check the wire for poor contact or damage.

13. The robot stops when encountering unknown obstacles, with the red light flashing and no warning sound:

- A. Use the remote control to move the robot to a safe position, or gently pull the safety rope back to the robot, keeping it as close to the glass as possible to avoid falling.
- B. Remove any obstacles on the window.
- C. Check if there is an air leak causing the issue.

14. Arc marks on polished glass when light shines at night:

For the first time, turn off the water spray function, clean the glass with a dry cloth to remove any sand, and replace the cloth. For the second wipe, clean again, replace the cloth, turn on the water spray function, or keep the upper cleaning wheel dry and clean, spraying a small amount of detergent or alcohol on the lower cleaning wheel (1 or 2 sprays). Do not completely wet the cloth, as it will affect the operation.

15. The robot has cleaned all the windows but doesn't stop automatically:

Press the start/pause button to end the operation.

16. The robot won't spray water:

- A. Ensure that the water spray function switch is turned on.
- B. Clean the ultrasonic nozzle with a soft, clean cloth.
- C. Check if the water tank has water and ensure the water is clean and pure.
- D. If air bubbles appear in the water tube between the tank and the spray nozzle, they may block the water flow and affect the spraying performance. Please follow the steps below:
Keep the water tank about 50% full and place the robot upright with the water tank facing upward. Open the water tank lid, then gently shake the robot from side to side. This will help the air in the tube escape through the top of the water tank, restoring normal water flow and spray function.

17. The spray nozzle does not spray water after the robot has not been used for a while:

- A. Pour out all the remaining water from the last use in the water tank, then rinse the tank thoroughly with clean water. (Limescale buildup may have clogged the spray nozzle.) After cleaning, refill the tank with clean water to restore normal functionality.
- B. Turn the robot upside down, apply a few drops of clean water directly to the nozzle area to moisten the atomizing plate. Let it sit for 15 minutes, then test again. The spraying function should resume.

18.Corner Cleaning Instructions

Due to the robot's round cleaning pad design, it is structurally limited in reaching all four corners of the window. For these areas, we recommend supplementing with manual cleaning to achieve the best overall results.

8. Warranty

Thank you for choosing our window cleaning robot.

Please carefully read the warranty terms and conditions and complete the warranty card. This card, together with your proof of purchase, entitles you to warranty services as specified.

Product Quality Warranty:

This product is covered by a ONE-YEAR warranty from the date of purchase. For online purchases, the warranty period is determined based on the online purchase record.

Kindly fill out the required information and send it, along with the robot, to our Customer Service Center for processing.

Customer Information

User Name:

Email:

Phone:

Address:

Post Code:

Robot Series Number:

Your Order Number:

Purchase Date:

Warranty Terms and Conditions

This product is guaranteed to be free from defects in workmanship and materials within the warranty period. If the product fails during normal and proper use within this period, we will, at our discretion, repair or replace the defective parts or the product itself.

The warranty does not apply under the following circumstances:

1. No valid warranty card or online purchase record.
2. The robot or its packaging lacks a serial number.
3. Damage caused by unauthorized disassembly or modification.
4. Malfunctions resulting from water damage, dropping, or other human-caused issues.

